

Matrix

LOW TABLES

A scenographic table with a strong visual impact. A contemporary design language, based on lightness and essentiality, turns into a complex play of geometric elements, with different heights and dimensions. Evolution of the Matrix bookcase, the table features a black chrome finishing and adjustable shelves covered in saddle leather with stitching on borders, according with the new mood permeating the collection.



Low table with varnished steel square tubular structure, welded and joined with retractable pins, with Black Chrome finishing.

Moveable table tops in MDF covered in Dark Brown saddle leather with visible tone on tone stitching in nylon thread.

LOW TABLES

Low table with varnished steel square tubular structure, welded and joined with retractable pins, with Black Chrome finishing.

Moveable table tops in MDF covered in saddle leather from the collection, with visible tone on tone stitching in nylon thread, or finished in Tay Veneered Dyed Smokey Grey.

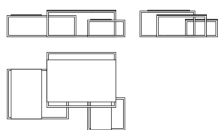

F.MTX.232.A

Central table

Standard features

L 154 D 102 H 35 cm
L 60.63 D 40.16 H 13.78 in

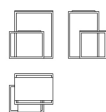

F.MTX.231.A

Side table

Standard features

L 57 D 50 H 62 cm
L 22.44 D 19.69 H 24.41 in

LOW TABLES

TOP



Tan Saddle Leather



Dark Brown Saddle
Leather



Black Saddle Leather



Tay Veneered Dyed
Smokey Grey

STRUCTURE



Black Chrome